

Patent Pending

REV	DESCRIPTION	DATE	APPROVAL

Magnet Grade: N35
Metal and magnet plated NICUNI

1/4-20 Threaded through hole with
Screw stopping feature

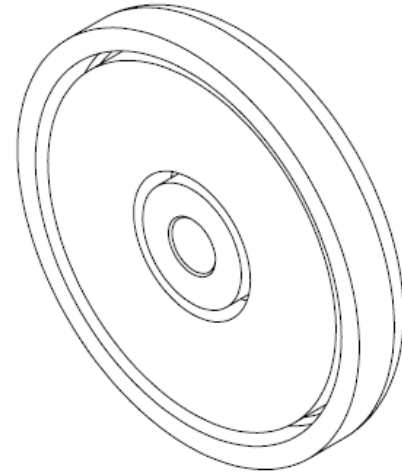
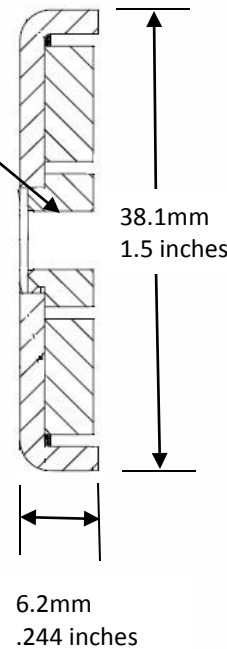

Test performed against 3mm or thicker metal.
Recommended to fasten against 3mm or thicker metal

Report No: 4787869508
Report Date: 2017-03-21



Results

Sample No.	Condition	Comment
889260	As received	None

Table 4

Sample #	Maximum Load (lbs.)
1	107
2	107
3	97.2
4	93.3
5	94.0
Avg.	99.6

Please read before us. Disclaimer: Winnie Industries neither assumes nor accepts any liability for damages resulting from the handling or use of magnets. With your purchase, the buyer confirms that you have read and understood the following warnings: the buyer agrees that he/she is responsible for all damages and injuries caused by the magnets, which include personal injuries, property damages and magnet damages. The buyer must agree with the terms before purchase. Pull forces we have provided are estimates only, we are not responsible for any inaccuracy of the magnet pull force. Please test the pull force before any usage.
Magnets are very strong. Handling them with care is necessary to prevent personal injuries, property damages and magnet damages. Can be harmful to pacemaker wearers and others with medical implants.



Release Approval: _____
Release Date: _____
Customer Approval: _____

Tolerances:
X = +/- 0.02in
XX = +/- 0.01in
XXX = +/- .005in
Unless Otherwise Specified

Proprietary Rights:
All information that is contained within is proprietary. Not for unauthorized use or disclosure.

Title: 1/4-20 Threaded Magnetic Mount

Size: A	Scale: None	Part Number: MAG1420	Rev: JW
Date: _____	Drawn by JW X		
Drawing Number _____	Sheet 1 of X		